

INSULATED
CONCRETE FORM

CONCRETE CORE
150 TO 200mm

MARK PIPE ROUTE & USE A HOT
KNIFE OR ROUTER TO CUT A GROVE
INTO THE FORM, CUTTING OF
FURRING STRIPS WILL BE AVOIDED IF
HORIZONTAL RUNS ARE PLACED
WITHIN THE 80MM ZONE BETWEEN
THE TOP OF ONE & THE BOTTOM OF
THE NEXT FORM (AFTER PLACEMENT
OF CONCRETE ONLY)

FOR OTHER
LOCATIONS OF
HORIZONTAL RUNS
FROM THAT SHOWN,
FURRING STRIPS WILL
NEED TO BE CUT.

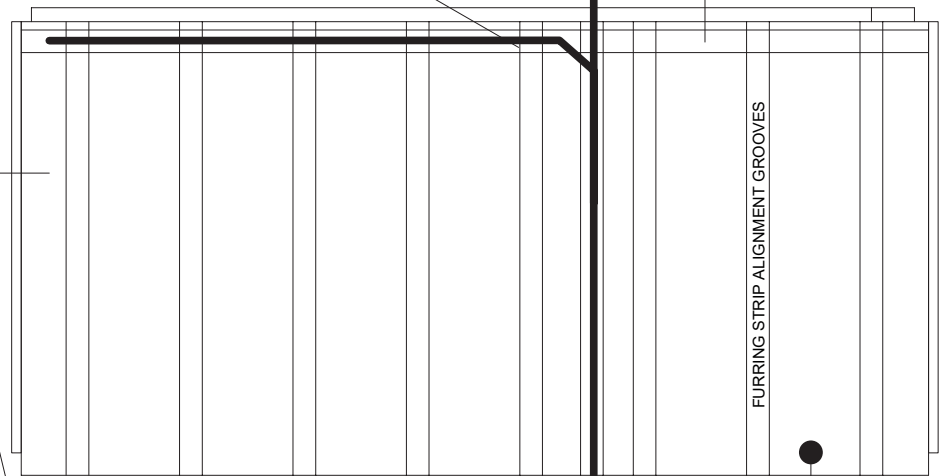
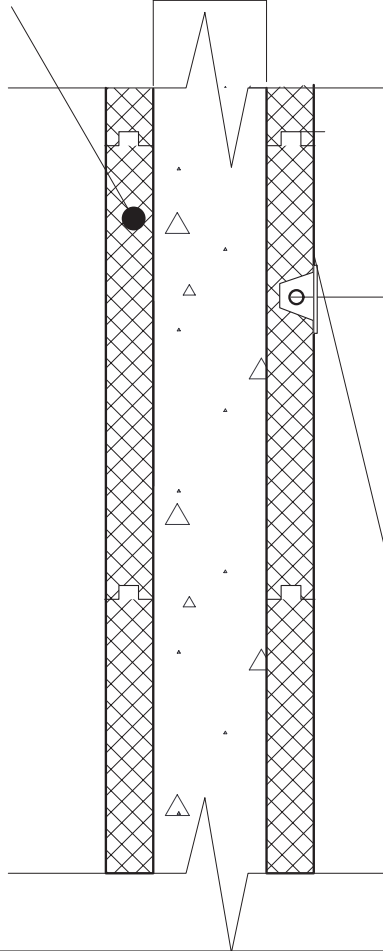

PROTECTION PLATE
OVER SERVICE RUN
FIXED BACK TO
FURRING STRIPS

INSULATED
CONCRETE FORM

NOTE: FOR ELECTRICAL CABLING, USE ONLY 'LOW SMOKE &
FIRE' LSOH WIRING CABLES

NOTE: ALTHOUGH IT MAY NOT BE NECESSARY FOR REINFORCEMENT TO BE INCORPORATED FOR STRUCTURES UP TO THREE STOREYS IN HEIGHT, STRUCTURES UP TO FOUR STOREYS AND INDIVIDUAL SITE CONDITIONS MAY DICTATE OTHERWISE & THEREFORE AN ENGINEER / ARCHITECT SHOULD BE CONSULTED IN THESE CIRCUMSTANCES. ALL DETAILS ARE TO CONSTRUCTED IN ACCORDANCE WITH CURRENT BUILDING CODES AND REGULATIONS. POLYSTEEL UK RESERVES THE RIGHT TO CHANGE INFORMATION SHOWN WITHOUT NOTICE

POLYSTEEL

POLYSTEEL Services runs within EPS



SCALE: 1:10

APPROVED BY:

DRAWN BY: CSW

DATE: JUNE 2005

REVISED: 08/03/19

Copyright 2005

DRWG. No.

POLYSTEEL UK Ltd

09/DET11

Tel: 01722 446 594

www.polysteel.co.uk